

Amphenol

608 Series

Circular Environmental Connectors

Approved to BS9522 F0020 (Pattern 608)

CE30



Design Features

- Keyway Polarisation.
- Ni Aluminium Bronze Shells.
- Threaded Anti Vibration coupling mechanism.
- Crimp or Solder Contacts.
- -55° to + 125° C Temp Range
- High Impact Strength

The Amphenol 608 series is a range of nickel aluminium bronze connectors with a 2 start acme thread coupling mechanism. The rugged design features and highly corrosion resistant materials make this connector series ideal for marine applications where equipment is continually exposed to rough treatment and salt laden atmosphere.

Connector Styles

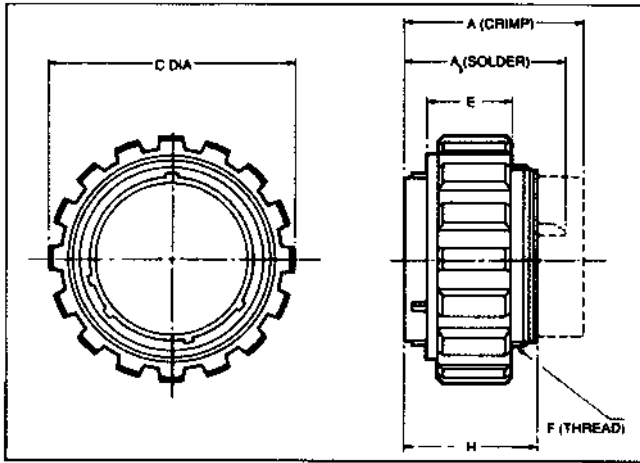

Straight Plug

British Standard Part No C2560-xx-xx-xxxx
Amphenol Part No (Crimp) 608-36T-xx-xxxx
(Solder) 608-56T-xx-xxxx

| SHELL SIZE | A MAX. | | A ₁ MAX. | | C DIA MAX. | | E MAX. | | F THREAD (CLASS 2A) | H MAX. | |
|------------|--------|------|---------------------|------|------------|------|--------|-----|----------------------|--------|------------|
| | mm | in. | mm | in. | mm | in. | mm | in. | | mm | in. |
| 8 | | | | | 21.1 | .83 | | | 14.8 .58 | | 22.98 .905 |
| 10 | | | | | 23.8 | .94 | | | | | |
| 12 | | | | | 28.2 | 1.11 | | | | | |
| 14 | | | | | 31.4 | 1.24 | | | | | |
| 16 | 32.9 | 1.30 | 25.4 | 1.00 | 36.5 | 1.44 | | | 1 1/16 - 20 U.N.E.F. | | |
| 18 | | | | | 39.3 | 1.55 | | | 1 1/16 - 18 U.N.E.F. | | |
| 20 | | | | | 42.5 | 1.67 | | | 1 3/16 - 18 U.N.E.F. | | |
| 22 | | | | | 45.3 | 1.78 | | | 1 3/16 - 18 U.N.E.F. | | 24.89 .980 |
| 24 | | | | | 48.4 | 1.91 | | | 1 7/16 - 18 U.N.E.F. | | |

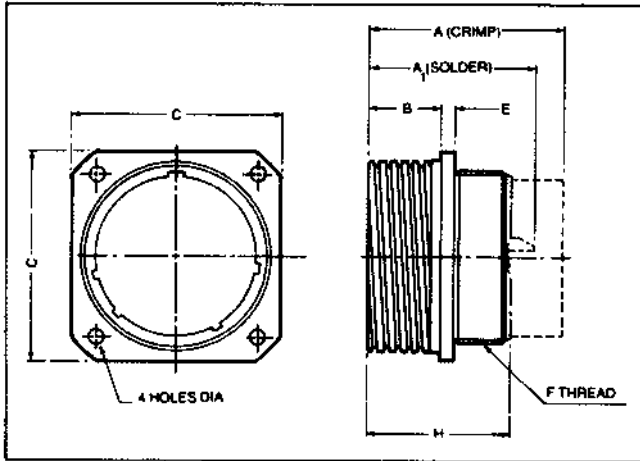

Wall Mount Receptacle

British Standard Part No C2561-xx-xx-xxxx
Amphenol Part No (Crimp) 608-30T-xx-xxxx
(Solder) 608-50T-xx-xxxx
Max Panel Thickness, Shell Size 8-18, 0.10in (2.6mm)
20-24, 0.24in (6.1 mm)

| SHELL SIZE | A MAX. | | A ₁ MAX. | | B MAX. | | C MAX. | | E MAX. | | F THREAD (CLASS 2A) | | MAX. | | D DIA ± .005 | |
|------------|--------|------|---------------------|------|--------|-----|--------|------|--------|-----|----------------------|------------|----------------------|-----|--------------|--------|
| | mm | in. | mm | in. | mm | in. | mm | in. | mm | in. | mm | in. | mm | in. | mm | in. |
| 8 | | | | | | | 21.1 | .83 | | | | 22.98 .905 | | 3.1 | .12 | ± .005 |
| 10 | | | | | | | 24.3 | .96 | | | | | | | | |
| 12 | | | | | | | 26.6 | 1.05 | | | | | | | | |
| 14 | 32.9 | 1.30 | 25.6 | 1.01 | 11.7 | .46 | 29.0 | 1.15 | 1.8 | .07 | 1 1/16 - 20 U.N.E.F. | | | | | |
| 16 | | | | | | | 31.2 | 1.23 | | | | | 1 3/16 - 20 U.N.E.F. | | | |
| 18 | | | | | | | 33.8 | 1.33 | | | 1 1/2 - 18 U.N.E.F. | | | | | |
| 20 | | | | | | | 37.0 | 1.46 | | | 1 3/16 - 18 U.N.E.F. | | | | | |
| 22 | 34.6 | 1.37 | 27.2 | 1.07 | 14.8 | .58 | 40.1 | 1.58 | 2.6 | .10 | 1 3/16 - 18 U.N.E.F. | 26.41 | 1.040 | | | |
| 24 | | | | | | | 43.3 | 1.71 | | | 15.5 | | | .61 | 43.3 | 1.71 |

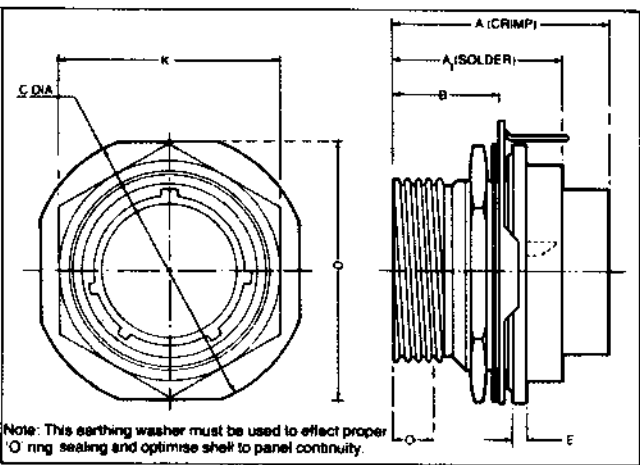

Jam Nut Receptacle

Single Hole Fixing (With Accessory Thread)
British Standard Part No C2562
Amphenol Part No (Crimp) 608-37T-xx-xxxx
(Solder) 608-57T-xx-xxxx
Max Panel Thickness, Shell Size 8-18, 0.10 in (2.6mm)
20-24, 0.24in (6.1 mm)

| SHELL SIZE | A MAX. | | A ₁ MAX. | | B MAX. | | C MAX. | | D MAX. | | E MAX. | | K MAX. | |
|------------|--------|------|---------------------|------|--------|-----|--------|------|--------|------|--------|-----|--------|------|
| | mm | in. | mm | in. | mm | in. | mm | in. | mm | in. | mm | in. | mm | in. |
| 8 | | | | | | | 27.4 | 1.08 | 24.3 | .96 | | | 19.3 | .76 |
| 10 | | | | | | | 30.5 | 1.20 | 27.4 | 1.08 | | | 22.7 | .89 |
| 12 | 32.9 | 1.30 | 30.0 | 1.18 | 17.7 | .70 | 35.4 | 1.39 | 32.2 | 1.27 | 3.3 | .13 | 27.2 | 1.07 |
| 14 | | | | | | | 38.4 | 1.51 | 35.4 | 1.39 | | | 30.5 | 1.20 |
| 16 | | | | | | | 41.7 | 1.64 | 38.5 | 1.52 | | | 33.6 | 1.32 |
| 18 | | | | | | | 44.7 | 1.76 | 41.6 | 1.64 | | | 36.9 | 1.45 |
| 20 | | | | | | | 49.6 | 1.95 | 46.5 | 1.83 | | | 39.9 | 1.57 |
| 22 | 34.6 | 1.37 | 32.7 | 1.29 | 22.5 | .89 | 57.6 | 2.07 | 49.7 | 1.96 | 4.1 | .16 | 43.2 | 1.70 |
| 24 | | | | | | | 23.6 | .93 | 55.8 | 2.20 | | | 52.8 | 2.08 |

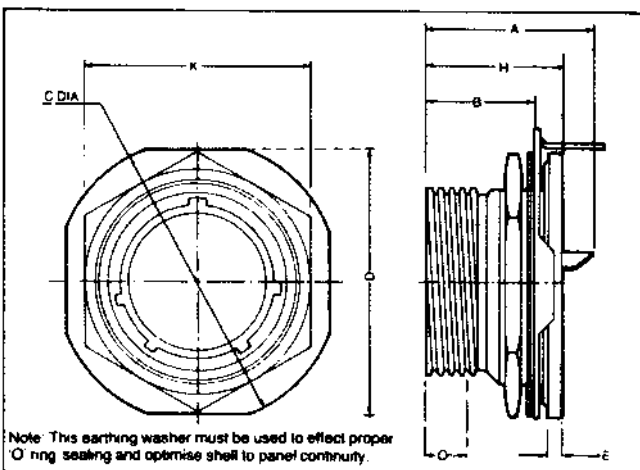

Jam Nut Receptacle

Single Hole Fixing (No Accessory Thread, Solder Contacts only)
British Standard Part No C2563-xx-xx-xxxx
Amphenol Part No (Solder) 608-57A-xx-xxxx
Max Panel Thickness, Shell Size 8-18, 0.10in (2.6mm)
20-24, 0.24in (6.1 mm)

| SHELL SIZE | A MAX. | | B MAX. | | C MAX. | | D MAX. | | E MAX. | | H MAX. | | K MAX. | |
|------------|--------|------|--------|-----|--------|------|--------|------|--------|-----|--------|------|--------|------|
| | mm | in. | mm | in. | mm | in. | mm | in. | mm | in. | mm | in. | mm | in. |
| 8 | | | | | 27.4 | 1.08 | 24.3 | .96 | | | | | 19.3 | .76 |
| 10 | | | | | 30.5 | 1.2 | 27.4 | 1.08 | | | | | 22.7 | .89 |
| 12 | 25.6 | 1.01 | 17.7 | .70 | 35.4 | 1.39 | 32.2 | 1.27 | 3.3 | .13 | 21.4 | .84 | 27.2 | 1.07 |
| 14 | | | | | 38.4 | 1.51 | 35.4 | 1.4 | | | | | 30.5 | 1.2 |
| 16 | | | | | 41.7 | 1.64 | 38.5 | 1.52 | | | | | 33.6 | 1.32 |
| 18 | | | | | 44.7 | 1.76 | 41.6 | 1.64 | | | | | 36.9 | 1.45 |
| 20 | | | | | 49.6 | 1.95 | 46.5 | 1.83 | | | | | 39.9 | 1.57 |
| 22 | 27.2 | 1.07 | 22.5 | .89 | 52.6 | 2.07 | 49.7 | 1.96 | 4.1 | .16 | 27.0 | 1.06 | 43.2 | 1.7 |
| 24 | | | | | 23.6 | .93 | 55.8 | 2.20 | | | | | 52.8 | 2.08 |

Insert Arrangements

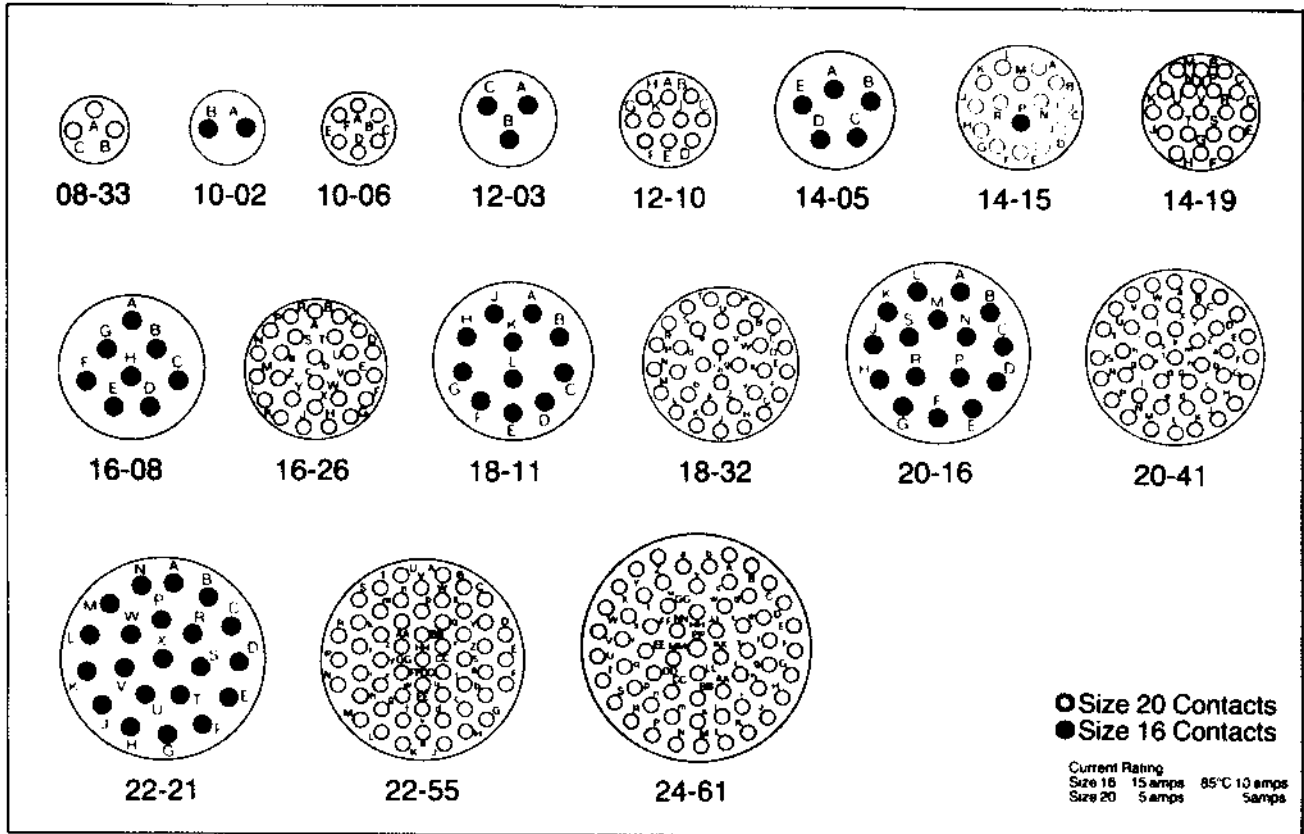

Panel Mounting Details

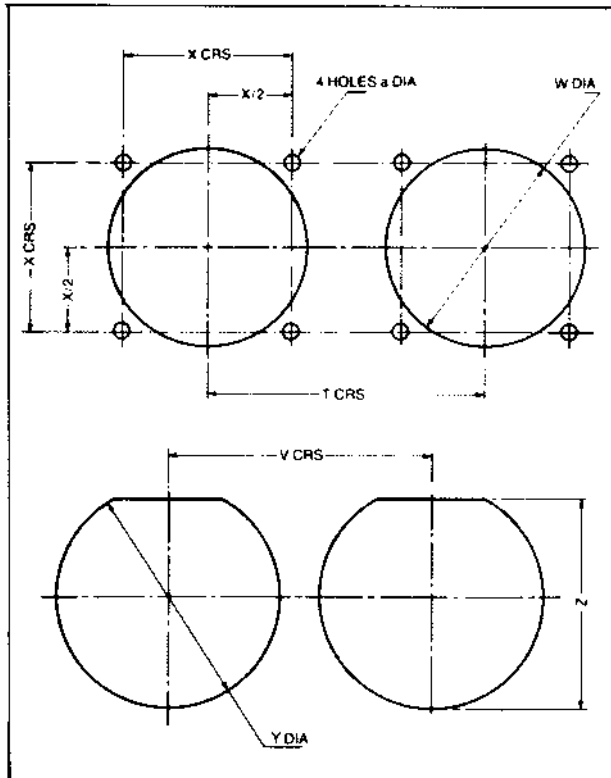

| Arrangement | Crimp | Solder | No Contacts | Contact | Size | Rating |
|-------------|-------|--------|-------------|---------|------|--------|
| 08-33 | X | X | 3 | 20 | | 1 |
| 10-02 | X | X | 2 | | 16 | 2 |
| 10-06 | X | X | 6 | 20 | | 1 |
| 12-03 | X | X | 3 | 16 | | 2 |
| 12-10 | X | X | 10 | 20 | | 1 |
| 14-05 | X | X | 5 | 16 | | 2 |
| 14-15 | X | X | 15 | 20 | 16 | 1 |
| 14-19 | X | X | 19 | 20 | | 1 |
| 16-08 | X | X | 8 | 16 | | 2 |
| 16-26 | X | X | 26 | 20 | | 1 |
| 18-11 | X | X | 11 | 16 | | 2 |
| 18-32 | X | X | 32 | 20 | | 1 |
| 20-16 | X | X | 16 | 16 | | 2 |
| 20-41 | X | X | 41 | 20 | | 1 |
| 22-21 | X | X | 21 | 16 | | 2 |
| 22-55 | X | X | 55 | 20 | | 1 |
| 24-61 | X | X | 61 | 20 | | 1 |

| SHELL SIZE | a dia | | T CRS MIN | | W DIA | | X | | V CRS MIN | | Y DIA | | Z | |
|------------|-------|-------|-----------|-------|-------|-------|-------|--------|-----------|-------|-------|-------|-------|-------|
| | ±.13 | ±.005 | ±.25 | ±.010 | ±.25 | ±.010 | CRS | (T.P.) | ±.13 | ±.005 | ±.13 | ±.005 | ±.13 | ±.005 |
| | mm. | in. | mm. | in. | mm. | in. | mm. | in. | mm. | in. | mm. | in. | mm. | in. |
| 8 | | | 22.7 | .89 | 14.3 | .56 | 15.09 | .954 | 27.4 | 1.08 | 15.90 | .626 | 14.94 | .588 |
| 10 | | | 25.4 | 1.00 | 17.3 | .68 | 18.26 | .719 | 30.5 | 1.2 | 18.92 | .745 | 17.91 | .705 |
| 12 | | | 29.8 | 1.18 | 21.4 | .84 | 20.62 | .812 | 35.4 | 1.39 | 23.70 | .933 | 22.33 | .879 |
| 14 | | | 33.0 | 1.30 | 24.4 | .96 | 23.01 | .906 | 38.4 | 1.51 | 26.77 | 1.054 | 25.45 | 1.002 |
| 16 | | | 38.1 | 1.50 | 27.7 | 1.09 | 24.61 | .969 | 41.7 | 1.64 | 29.95 | 1.179 | 28.65 | 1.128 |
| 18 | | | 40.9 | 1.61 | 30.8 | 1.21 | 26.97 | 1.062 | 44.7 | 1.76 | 33.12 | 1.304 | 31.83 | 1.253 |
| 20 | | | 44.0 | 1.74 | 3.41 | 1.34 | 29.36 | 1.156 | 49.3 | 1.94 | 36.30 | 1.429 | 35.00 | 1.378 |
| 22 | | | 46.8 | 1.85 | 37.1 | 1.46 | 31.75 | 1.250 | 52.8 | 2.08 | 39.47 | 1.554 | 38.18 | 1.503 |
| 24 | 4.2 | .17 | 50.0 | 1.97 | 40.1 | 1.59 | 34.93 | 1.375 | 55.8 | 2.20 | 42.65 | 1.679 | 41.35 | 1.628 |

| Voltage Rating | 1 | 2 |
|--------------------|------|------|
| Sea Level | | |
| Working Voltage DC | 700 | 1250 |
| Voltage Proof DC | 2100 | 3000 |

*Please note that the establishment of electrical safety factors is left entirely in the designer's hands, since he is in the best position to know what peak voltages, switching surges, transients, etc. can be expected in a particular circuit

Accessories

Protective Cap (Straight Plug)

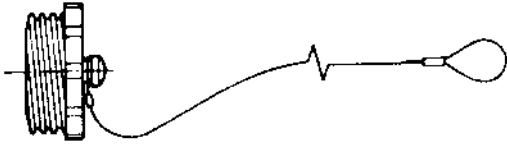

Terylene Cord
 British Standard Part No. A2567-xx
 Amphenol Part No. 608-567-xx
 Plastic Coated S/Steel Wire
 British Standard Part No. A2569-xx
 Amphenol Part No. 608-569-xx

Protective Cap (Receptacle)

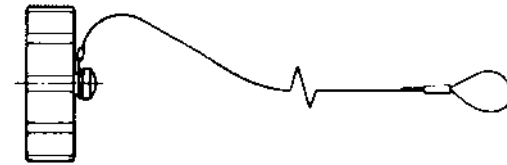

Terylene Cord
 British Standard Part No. A2566-xx
 Amphenol Part No. 608-566-xx
 Plastic Coated S/Steel Wire
 British Standard Part No. A2568-xx
 Amphenol Part No. 608-568-xx

Grommet Nut and Ferrule Assy (Straight Plug and Wall Mount Receptacle)

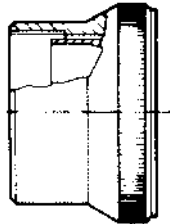

British Standard Part No. A2581-xx-x
 Amphenol Part No. 608-581-xx

Grommet Nut and Ferrule Assy (Jam Nut Receptacle)

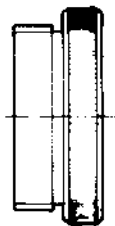

British Standard Part No. A2580-xx-x
 Amphenol Part No. 608-580-xx

Grommet Seal (Solder Contact Connectors Only)

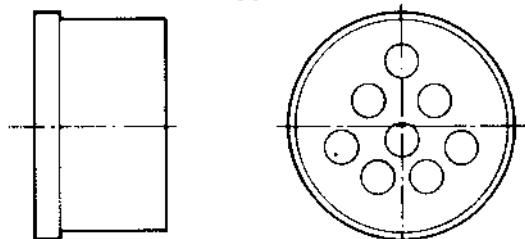

British Standard Part No. A2584-xx-xx
 Amphenol Part No. 608-584-xx-xx

Connector Ordering Codes

Amphenol Part No

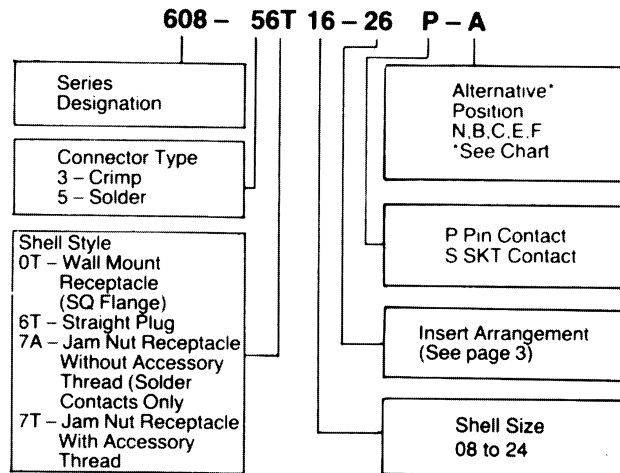

British Standard Part No

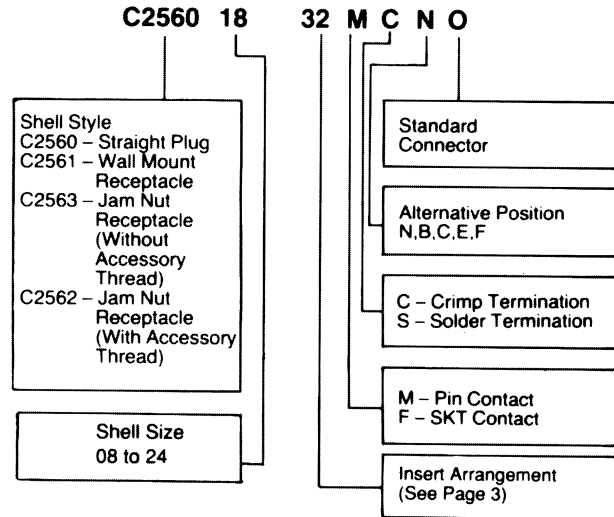

Accessory and Tool Ordering Code

Amphenol Part No

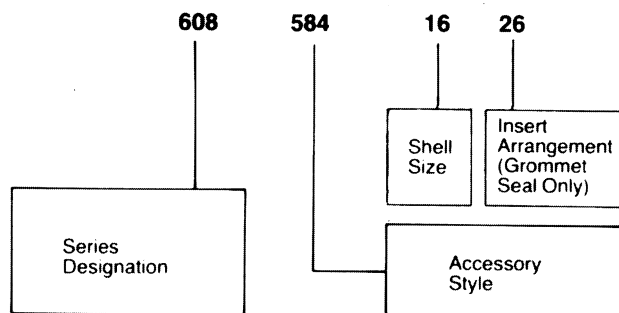

BS Part No

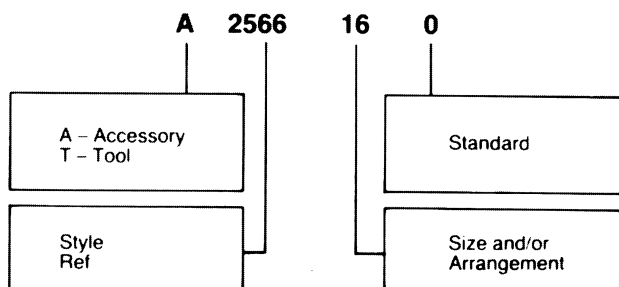

Keyway Orientation

| ANGLE SHELL SIZE | ∞° | | | | |
|---------------------|----------------|-----|-----|-----|-----|
| | 'N' | 'B' | 'C' | 'E' | 'F' |
| 08 | 105 | - | - | 118 | 82 |
| 10 | 105 | 85 | 125 | 115 | 85 |
| 12 | 105 | 89 | 121 | 115 | 85 |
| 14 | 105 | 91 | 119 | 75 | 120 |
| 16 | 105 | 93 | 117 | 75 | 120 |
| 18 | 105 | 95 | 115 | 75 | 120 |
| 20 | 105 | 95 | 115 | 75 | 120 |
| 22 | 105 | 97 | 113 | 75 | 120 |
| 24 | 105 | 97 | 113 | 75 | 120 |

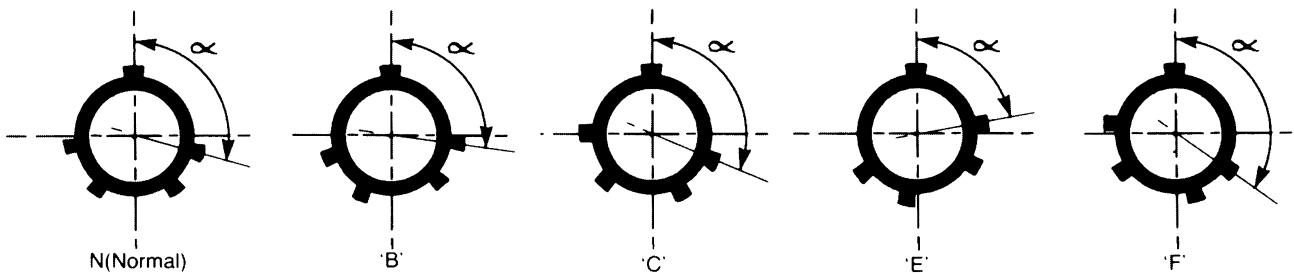

Assembly Instructions

Connectors are supplied with a full complement of contacts but can be supplied separately.

| Contact Size | Colour Code | Contact Part Nos | Quantity Per Pack | Suitable Wire Sizes | | Permissible Insulation O.D. range for Grommet sealing | Stripping Lengths |
|--------------|-------------|-------------------------------|-------------------|---------------------|---------------|---|-------------------|
| | | | | A W G | in mm | | |
| 20 | RED | pin: 162GB-149-20,000-05-pk25 | 25 | 2012224 | 0.032 - 0.020 | 0.047 - 0.085 | 0.220 - 0.260 |
| | | skt: 16268-101-20,000-05-pk25 | 25 | | 0.81 - 0.51 | | |
| 16 | BLUE | pin: 162GB-149-16,000-05-pk25 | 25 | 16:18:20 | 0.051 - 0.032 | 0.066 - 0.109 | 0.220 - 0.260 |
| | | skt: 16268-101-16,000-05-pk25 | 25 | | 1.295 - 0.81 | | |

Wire Stripping

Strip 5.6mm (.220 in.) to 6.6mm (.260 in.) of insulation from end of wire for both size 20 and 16 contacts taking care not to cut or nick strands. If ends fray twist them back to their original lay.

Crimp Wire to Contact

Use (M22520 1-01) with Turret Head (M22520/1-02). Release and rotate Turret Knob to proper contact size (as per colour code) and lock adjust Selector Knob on handle to correct wire size (see table). Insert stripped wire into Contact Pocket until it is visible through inspection hole. Fully seat Contact in Crimp Tool Positioner and close handles in one full stroke (The Rachel will not release until tool has completed full stroke). Inspect Crimp for wire visibility through Inspection Hole.

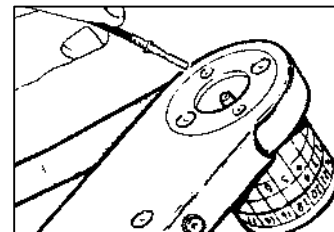

Crimping Jaw Setting

| Contact Size | Wire Size | Crimp Jaw Setting |
|--------------|-----------|-------------------|
| 20 | 24 | No 2 |
| | 22 | No 3 |
| | 20 | No 4 |
| 16 | 20 | No 4 |
| | 18 | No 5 |
| | 16 | No 6 |

| Contact Size | Insertion Tool Part No | Removal Tool Part No | Grommet Sealing Plug |
|--------------|-----------------------------|-----------------------------|----------------------|
| 20 | MS 24256A-20 (T 2594-20) | MS 242568-20 (T 2018-20) | 162GB-130-20000 |
| 16 | MS 24256A-16 (T 2594-16) | MS24256R-16 (T 2018-16) | 162GB-130-16000 |

Contact Insertion

Select the proper insertion tool for the size of contact as per table. The insertion tool and procedure are the same for both pin and socket contacts. Slide rear accessory and sleeve over wire bundle. Lay wire in groove of insertion tool and slide contact into front of 1001 until it is properly located in tool probe. Insert contact into the correct hole in the rear face of the grommet. Keeping contact in line with the axis of the hole, apply a smooth even push on the tool until the contact is fully seated in position. Note it is essential that the contact and tool are correctly aligned with the axis of hole during insertion to prevent damage to contacts. Withdraw tool at right angles to grommet surface until completely free of connector. All contacts must be inserted whether in circuit or not and the appropriate size sealing plug used behind any contacts that are not wired. Push the sealing plug by hand until it is fully seated.

Contact Removal

CAUTION extra care is required in this operation to prevent damage to the connector. Remove the rear accessory and sleeve and slide back on wire bundle. Select the proper removal tool for the size of contact from table. The same tool is used for both pin and socket contacts. Position the removal tool over the contacts to be removed and push until tool probe is fully bottomed, shown when indicator band enters insert hole. Tool is inserted to first band only when removing pin contacts and to second band for socket contacts removal. Slide the plunger knob forward to remove contact. NB removed tool is inserted into hole of connector.

Amphenol® 608 Specials

Hermetic Receptacles

Wall Mount, Jam Nut, Soldermount

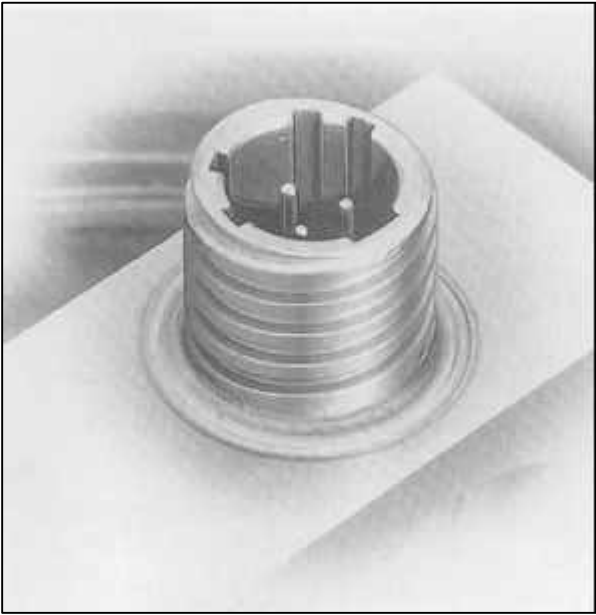

Consult Factory for Availability.

Combat Serial Highway

100Ω Data Bus, DEF Stan 00-19

Amphenol 716 Series



Full Range Tooled - Consult Factory for Data.

Low Pass EMI Filter Receptacles

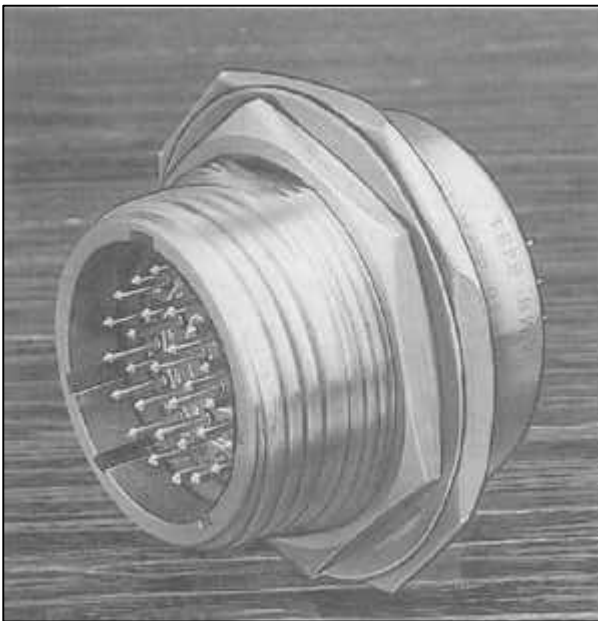

Consult Factory for Availability.

Through Bulkhead Receptacles

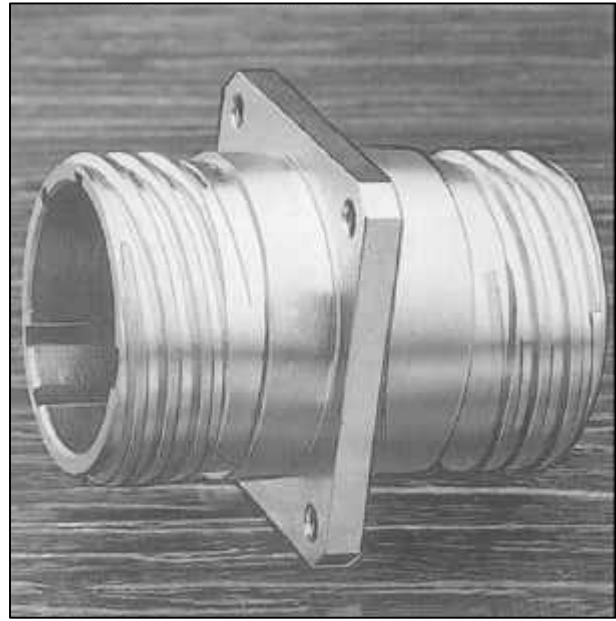

Consult Factory for Availability.

NOTICE

Products are sold subject to Amphenol's conditions of sale ("the standard conditions"). All specifications and statements contained herein are believed to be correct at the time of printing, but no representation or warranty, express or implied, is given as to any specification or statement contained herein. Product specifications including performance characteristics are typical only and subject to deviation. Specifications are also subject to change without notice. User should not assume that all safety measures are indicated or that other measures may not be required. No representation or Warranty, express or implied, is given that any use of products (including any stated or suggested use) does not infringe any patent, registered design or other third party rights and no stated or suggested use of products can be taken to recommend any such infringement.

Amphenol Limited

Thanet Way, Whitstable, Kent, CT5 3JF, England.

Telephone: (01227) 773200 Fax: (01227) 276571

Amphenol

608 Series

RFI sealed backshells for
608 crimp connectors

Sealed straight outlet

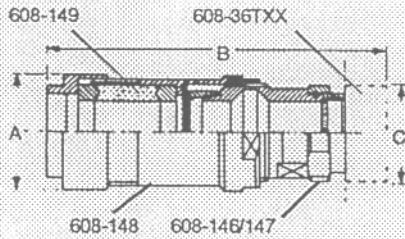

| Shell size | Dia 'A' max | Length 'B' max | Dia 'C' max |
|------------|-------------|----------------|-------------|
| 8 | 21.00 | 106.70 | 21.03 |
| 10 | 23.8 | 106.70 | 23.80 |
| 12 | 28.15 | 106.70 | 28.27 |
| 14 | 31.30 | 106.70 | 31.34 |
| 16 | 36.45 | 111.70 | 36.50 |
| 18 | 39.25 | 111.70 | 39.27 |
| 20 | 42.40 | 113.40 | 42.42 |
| 22 | 45.34 | 113.40 | 45.21 |
| 24 | 48.00 | 113.40 | 48.39 |

Front sub-assembly

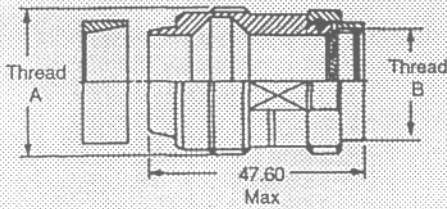

| Shell size | Thread 'A' | Thread 'B' | Part No | Nato No 5935-99-654- |
|------------|---------------------------------|---------------------------------|------------|----------------------|
| 8 | $1\frac{1}{16}$ X 20 UN-2A | $\frac{7}{16}$ X 28 UNEF-2B | 608-146-08 | 6250 |
| 10 | $\frac{13}{16}$ X 20 UNEF-2A | $\frac{9}{16}$ X 24 UNEF-2B | 608-146-10 | 6251 |
| 12 | $\frac{11}{16}$ X 20 UNEF-2A | $\frac{11}{16}$ X 24 UNEF-2B | 608-146-12 | 6252 |
| 14 | $1\frac{1}{16}$ X 20 UN-2A | $\frac{13}{16}$ X 20 UNEF-2B | 608-146-14 | 6253 |
| 16 | $1\frac{1}{4}$ X 20 UN-2A | $\frac{15}{16}$ X 20 UNEF-2B | 608-146-16 | 6254 |
| 18 | $1\frac{3}{8}$ X 20 UN-2A | $1\frac{1}{16}$ X 18 UNEF-2B | 608-146-18 | 6255 |
| 20 | $1\frac{1}{2}$ X 20 UN-2A | $1\frac{3}{16}$ X 18 UNEF-2B | 608-146-20 | 6256 |
| 22 | $1\frac{9}{16}$ X 20 UN-2A | $1\frac{5}{16}$ X 18 UNEF-2B | 608-146-22 | 6257 |
| 24 | $1\frac{11}{16}$ X 20 UN-2A | $1\frac{7}{16}$ X 18 UNEF-2B | 608-146-24 | 6258 |

Reduced front outlet sub-assembly

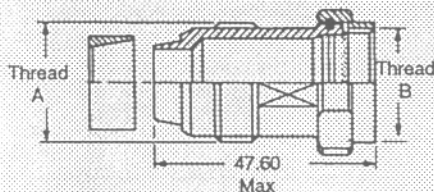

| Shell size | Thread 'A' | Thread 'B' | Part No | Nato No. 5935-99-654 | |
|------------|------------|---------------------------------|----------------------------------|----------------------|------|
| Connector | Outlet | | | | |
| 10 | 8 | $\frac{11}{16}$ X 20 UN-2A | $\frac{9}{16}$ X 24 UNEF-2B | 608-147-10 | 6268 |
| 12 | 10 | $\frac{13}{16}$ X 20 UNEF-2A | $\frac{11}{16}$ X 24 UNEF-2B | 608-147-12 | 6269 |
| 14 | 10 | $\frac{13}{16}$ X 20 UNEF-2A | $\frac{13}{16}$ X 20 UNEF-2B | 608-147-14 | 6270 |
| 16 | 12 | $\frac{15}{16}$ X 20 UNEF-2A | $\frac{15}{16}$ X 20 UNEF-2B | 608-147-16 | 6271 |
| 18 | 14 | $1\frac{13}{16}$ X 20 UN-2A | $1\frac{1}{16}$ X 20 UNEF-2B | 608-147-18 | 6272 |
| 20 | 16 | $1\frac{1}{4}$ X 20 UN-2A | $1\frac{5}{16}$ X 18 UNEF-2B | 608-147-20 | 6273 |
| 22 | 16 | $1\frac{1}{4}$ X 20 UN-2A | $1\frac{5}{16}$ X 18 UNEF-2B | 608-147-22 | 6274 |
| 24 | 18 | $\frac{3}{8}$ X 20 UN-2A | $1\frac{11}{16}$ X 18 UNEF-2B | 608-147-24 | 6275 |

Amphenol Ltd
Marine Products

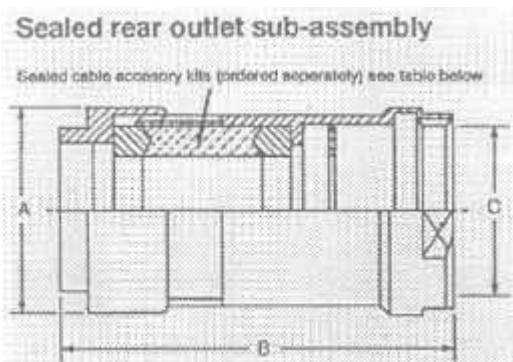

| Shell Size | 'A' dia max. | Length 'A' max. | Thread 'C' | Part No | Nato No 5935-99-654- |
|------------|--------------|-----------------|---|------------|----------------------|
| 8 | 21.00 | 65.55 | 1 ¹ / ₁₆ X 20 UN-2B | 608-148-08 | 6284 |
| 10 | 23.80 | 65.55 | 1 ³ / ₁₆ X 20 UNEF-2B | 608-148-10 | 6285 |
| 12 | 28.15 | 65.55 | 1 ⁵ / ₁₆ X 20 UNEF-2B | 608-148-12 | 6286 |
| 14 | 31.30 | 65.55 | 1 1 ¹ / ₁₆ X 20 UN-2B | 608-148-14 | 6287 |
| 16 | 36.45 | 70.55 | 1 1 ¹ / ₄ X 20 UN-2B | 608-148-16 | 6288 |
| 18 | 39.25 | 70.55 | 1 3 ³ / ₈ X 20 UN-2B | 608-148-18 | 6289 |
| 20 | 42.40 | 70.55 | 1 1 ¹ / ₂ X 20 UN-2B | 608-148-20 | 6290 |
| 22 | 45.34 | 70.55 | 1 9 ¹ / ₁₆ X 20 UN-2B | 608-148-22 | 6291 |
| 24 | 48.00 | 70.55 | 1 1 ¹ / ₁₆ X 20 UN-2B | 608-148-24 | 6292 |

| Rear section Shell size | Cable diameter (mm) | Part Number | Nato number 5935-99-654 |
|-------------------------|---------------------|--------------|-------------------------|
| 8 | 8mm to 4mm | 608-149-6302 | 6302 |
| 10 | 11mm to 7mm | 608-149-6303 | 6303 |
| | 8mm to 4mm | 608-149-6305 | 6305 |
| 12 | 14mm to 10mm | 608-149-6310 | 6310 |
| | 11 mm to 7mm | 608-149-6311 | 6311 |
| 14 | 17mm to 13mm | 608-149-6537 | 6537 |
| | 14mm to 10mm | 608-149-6314 | 6314 |
| | 11mm to 7mm | 608-149-6316 | 6316 |
| 16 | 20mm to 16mm | 608-149-6320 | 6320 |
| | 17mm to 13mm | 608-149-6322 | 6322 |
| | 14mm to 10mm | 608-149-6325 | 6325 |
| | 11 mm to 7mm | 608-149-6538 | 6538 |
| 18 | 23mm to 19mm | 608-149-6360 | 6360 |
| | 20mm to 16mm | 608-149-6361 | 6361 |
| | 17mm to 13mm | 608-149-6539 | 6539 |
| 20 | 14mm to 10mm | 608-149-6541 | 6541 |
| | 26mm to 22mm | 608-149-6542 | 6542 |
| | 23mm to 19mm | 608-149-6543 | 6543 |
| | 20mm to 16mm | 608-149-6335 | 6335 |
| | 17mm to 13mm | 608-149-6337 | 6337 |
| | 14mm to 10mm | 608-149-6544 | 6544 |
| 22 | 29mm to 25mm | 608-149-6545 | 6545 |
| | 26mm to 22mm | 608-149-6343 | 6343 |
| | 23mm to 19mm | 608-149-6546 | 6546 |
| | 20mm to 16mm | 608-149-6344 | 6344 |
| | 17mm to 13mm | 608-149-6547 | 6547 |
| 24 | 32mm to 28mm | 608-149-6548 | 6548 |
| | 29mm to 25mm | 608-149-6549 | 6549 |
| | 26mm to 22mm | 608-149-6550 | 6550 |
| | 23mm to 19mm | 608-149-6348 | 6348 |
| | 20mm to 16mm | 608-149-6349 | 6349 |
| | 17mm to 13mm | 608-149-6551 | 6551 |

Note: Size 20 seal plugs are supplied with each seal kit

Notice: Products are sold subject to AMPHENOL's condition of sale ("the standard conditions"). All specifications and statements are believed to be correct at the time of printing, but no representation of warranty, express or Implied is given as to any specification or statement contained herein. Product specifications including performance characteristics are typical only, and subject to deviation. Specifications are also subject to change without notice. User should not assume that all safety measures are indicated or that any other measures may not be required. No representation or warranty, express or Implied, is given that any use of products (including any stated or suggested use) does not infringe any patent, registered design or other third party rights and no suggested use of products can be taken to recommend such infringement.

Amphenol

AMPHENOL LIMITED
 Thanet Way, Whitstable, Kent CT5 3JF
 Tel. 0227 773200 Fax 0227 276571